

Hansen Safetylite® Compartment Lighting Systems

Another safety innovation from Hansen International, Inc.

HANSEN
INTERNATIONAL

Since 1920

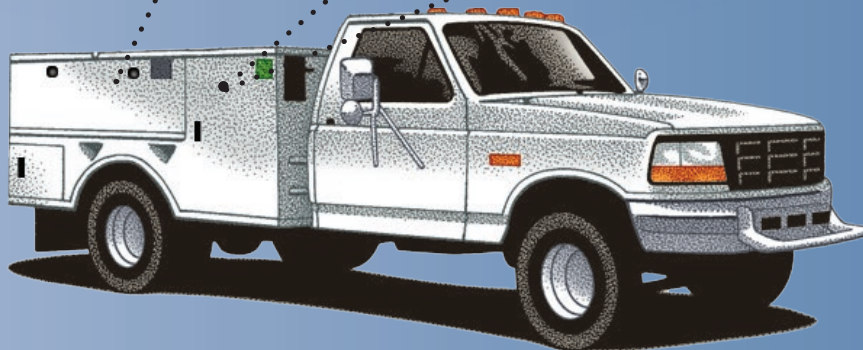
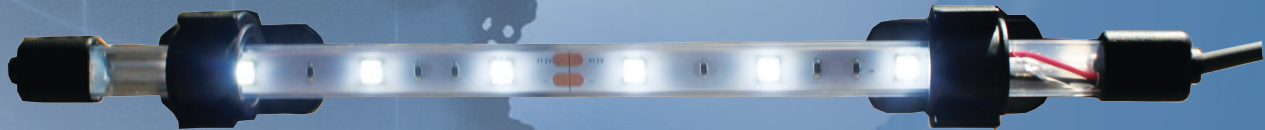

Features and Benefits

- Standard 12 Volt LED
- Shock and vibration resistant
- Rugged solid state design
- 12V rated life: 50,000 hours
- Waterproof to IP66 rating
- Exceeds compartment lighting requirements of NFPA 1901 standard 2009
- Easy to install or replace with snap-in feature
- 12V 120 lumens per foot of LED lights
- Standard Bright White
- Mounting clips have indexing feature allowing up to 3 fixed angle positions
- Manufactured in the USA
- Custom lengths are available
- 24" pig tail with 20 gauge automotive wire
- Tough polycarbonate tube enclosure that protects the LED circuit board
- Impact tested to over 50 lbs.
- 3 year limited warranty
- Easy connectability

Uses Include

- Compartment Lighting
- Operator Illumination
- Step Lighting
- Marine Applications
- Vehicle Cabs

Markets

- Fire and Emergency
- Utility
- Step Vans
- Specialty Bodies
- Truck
- RV
- Tool Box
- Electrical Enclosures

Options Available

- Rubber Boot Pin Switch
- LED Light Colors; Red, Blue, Green & Amber
- Custom Lengths are Available
- 24 Volt LED

Description	Part #	Length (inches)
12V,120 Lumens, 2 mounting clips, 24" coated wires	LED10WH12V-09	9
12V,120 Lumens, 2 mounting clips, 24" coated wires	LED10WH12V-18	18
12V,120 Lumens, 3 mounting clips, 24" coated wires	LED10WH12V-25	25
12V,120 Lumens, 3 mounting clips, 24" coated wires	LED10WH12V-30	30
12V,120 Lumens, 4 mounting clips, 24" coated wires	LED10WH12V-37	37
12V,120 Lumens, 5 mounting clips, 24" coated wires	LED10WH12V-49	49
12V,120 Lumens, 5 mounting clips, 24" coated wires	LED10WH12V-54	54
12V,120 Lumens, 6 mounting clips, 24" coated wires	LED10WH12V-65	65

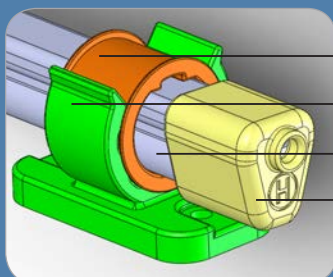

- Custom indexing clip
- Mounting bracket
- "H" Brilliant White® LED Module
- "H" end block with 24 inch coated lead wires